

'87 NSR250RK

FORMULA-III KIT PARTS LIST



エンジン主要諸元

・排気量	249
・内径×行程	54.0×54.5mm
・圧縮比	7.8 : 1
・最高出力	65ps 以上 /11,500rpm
・最大トルク	4.2kg-m 以上 /11,500rpm
・ミッション変速比 I	2.235 (38/18)
II	1.619 (34/21)
III	1.333 (32/24)
IV	1.154 (30/26)
V	1.074 (29/27)
VI	1.000 (28/28)

NSR250RK エンジン性能曲線

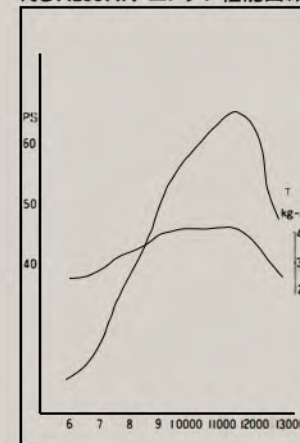

キット組込プロト車のためキット部品と一部異なる場合があります。

DOWNLOADED FROM NSR-WORLD.COM
REPRODUCED WITH THE PERMISSION OF HONDA MOTOR COMPANY
FOR USE ON NSR-WORLD.COM & nsr250.net ONLY.

※本仕様は改良のため予告なく変更する場合があります。
※当製品はレース仕様のため公道を走ることは出来ません。
尚、商品に関するお問合せはHRC本社テクニカルサービス
グループ 0484-81-2511まで。FAX-0484-77-6361
※SPフォミュラのパーツも表示してあります。

※No.の左側に・印のついている部品はHRC 専用部品です。ご注文はHRC 指定レーシングサー
ビスショップまたは下記に直接お願いします。

※使用個数に () がつけられている部品は構成部品又はオプション部品です。
※使用個数が "N" と示されている部品は必要に応じて選択して使用する部品です。

〒352 埼玉県新座市野火止8-18-4 (株)ホンダ・レーシング TEL 0484-77-9538 0484-77-9539

1-1

F-III KIT ASSY. <ENGINE>

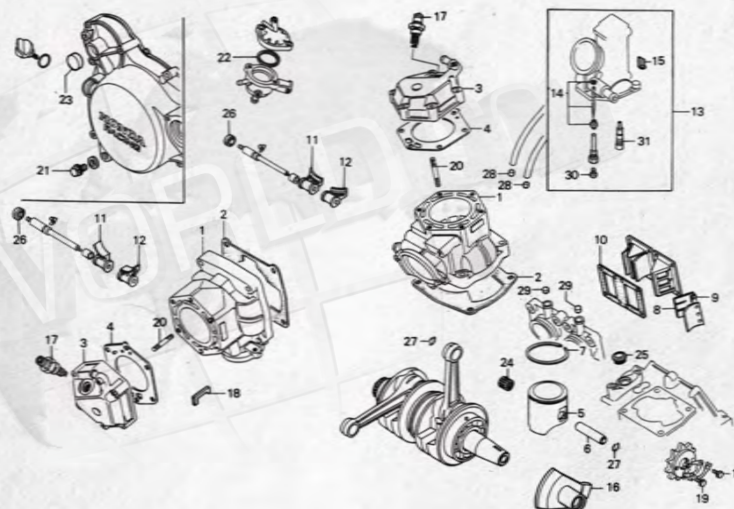

Ref. No.	Parts No.	Description	Reqd. No. F-III	SP-F	Price (¥)	Ref. No.	Parts No.	Description	Reqd. No. F-III	SP-F	Price (¥)
•	06110-NH3-000	ノービス F-III KIT ASSY.	○	—	313,500	•	16201-NH3-004	NEEDLE SET, jet (8TA)	(1)	—	1,200
•	06140-NH3-600	SP-FORMULA KIT ASSY.	—	○	5,600			ストレーツ径φ2455キャブセツティングキツ構成部品			
•	1 12101-NH3-000	CYLINDER	2	—	55,000	•	16202-NH3-004	NEEDLE SET, jet (8UA)	(1)	—	1,200
•	2 12192-KV3-000	GASKET, cylinder	2	—	105			ストレーツ径φ2485キャブセツティングキツ構成部品			
•	3 12210-NH3-000	HEAD, cylinder	2	—	7,000	•	15 16186-NH3-000	PLATE COMP., set	(2)	—	500
•	4 12251-KV3-003	GASKET, cylinder head	2	—	480			キャブセツティング構成部品			
•	5 13100-NF4-000	PISTON COMP.	2	—	4,600	•	16 31110-NH3-000	PLATE, pulser	1	—	16,600
•	6 13111-NH3-000	PIN, piston	2	—	500	•	17 31920-ND5-003	SPARK PLUG (COMPACT) 9.5	(2)	—	2,500
•	7 13121-NF4-000	RING, piston	2	—	1,200	•	31930-ND5-003	SPARK PLUG (COMPACT) 10.0	2	—	2,500
•	8 04103-ND5-760	VALVE ONLY, read	(4)	—	300	•	31940-ND5-003	SPARK PLUG (COMPACT) 10.5	(2)	—	2,500
•	9 14122-NH3-300	SPACER, reed valve	4	—	250	•	18 89001-NH3-000	GAUGE, RC valve	1	—	3,300
•	10 14132-KV3-000	GASKET, reed valve B	1	—	150			バルブ調整用治具			
•	11 14201-NH3-000	VALVE, flap R.	2	—	3,800	•	19 90001-NH3-000	BOLT, hex., special 6 x 12	2	2	450
•	12 14202-NH3-000	VALVE, flap L.	2	—	3,800	•	20 90032-KV3-000	BOLT, B. cylinder stud	12	—	70
•	13 16020-NH3-000	CARB. SETTING KIT ASSY.	1	—	10,000	•	21 90081-NC2-000	BOLT, drain 12 mm	1	1	120
•	16040-NH3-600	CARB. SETTING KIT ASSY.	—	1	3,300	•	22 90401-NH3-000	WASHER, thermostat	1	1	300
•	14 16012-NH3-004	NEEDLE SET, jet (8LA)	(2)	—	1,200	•	23 90871-733-003	PLUG, seal 28	1	1	155
		ストレーツ径φ2465キャブセツティングキツ構成部品				•	24 91008-NH3-000	BEARING, connecting rod S-end	2	—	700
•	16027-NH3-004	NEEDLE SET, jet (8MA)	(2)	—	1,200	•	25 91201-NH3-003	PLUG, seal 20	1	1	830
		ストレーツ径φ2475キャブセツティングキツ構成部品									
						•	26 91201-PA9-003	OIL SEAL 9 x 18 x 7	2	—	140

1-1

F-III KIT ASSY. <ENGINE>

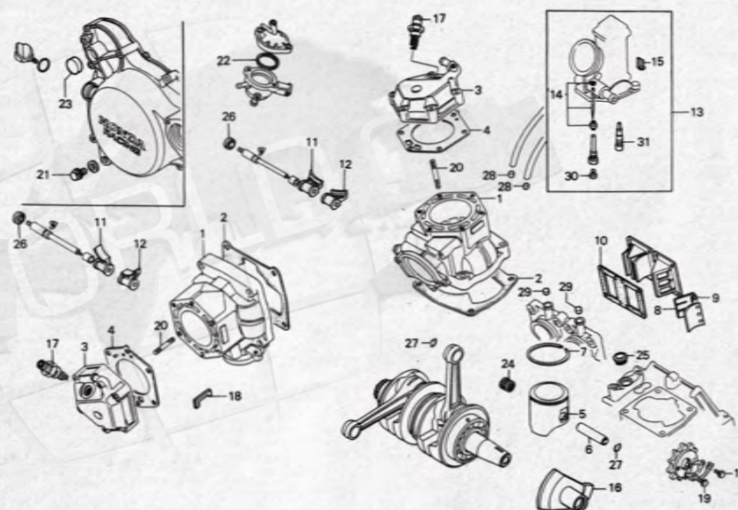

Ref. No.	Parts No.	Description	Reqd. No. F-III	SP-F	Price (¥)	Ref. No.	Parts No.	Description	Reqd. No. F-III	SP-F	Price (¥)
27	94601-14000	CLIP, piston pin 14 mm	4	—	15		99101-393-1520	JET, main #152	(2)	—	220
28	96205-03005	PLUG, cone type 3 x 5	2	1	10			キャブセッティングキット構成部品			
29	96205-12012	PLUG, cone type 12 x 12	2	—	10		31 99103-MA4-0400	JET, slow #40	(2)	(2)	440
	99101-393-1300	JET, main #130	—	(2)	220			キャブセッティングキット構成部品			
	99101-393-1320	JET, main #132	—	(2)	220						
		キャブセッティングキット構成部品									
	99101-393-1350	JET, main #135	—	(2)	220						
		キャブセッティングキット構成部品									
30	99101-393-1380	JET, main #138	(2)	(2)	220						
		キャブセッティングキット構成部品									
	99101-393-1400	JET, main #140	(2)	(2)	220						
		キャブセッティングキット構成部品									
	99101-393-1420	JET, main #142	(2)	(2)	220						
		キャブセッティングキット構成部品									
	99101-393-1450	JET, main #145	(2)	(2)	220						
		キャブセッティングキット構成部品									
	99101-393-1480	JET, main #148	(2)	—	220						
		キャブセッティングキット構成部品									
	99101-393-1500	JET, main #150	(2)	—	220						
		キャブセッティングキット構成部品									

1-2

F-III KIT ASSY. FRAME

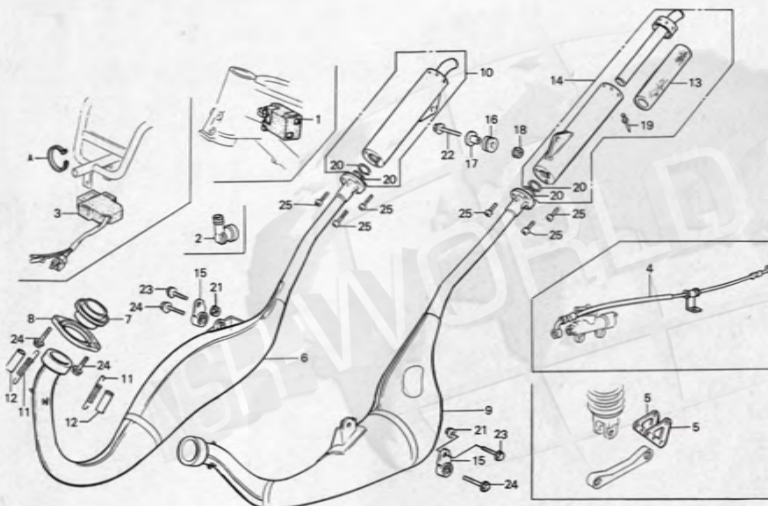

Ref. No.	Parts No.	Description	Reqd. No. ノーマル F-III	SP-F	Price (¥)	Ref. No.	Parts No.	Description	Reqd. No. ノーマル F-III	SP-F	Price (¥)
• 1	30400-NH3-000	UNIT ASSY., CD1	1	—	13,000	• 18	90301-473-003	NUT, U. 6 mm	(1)	—	135
• 2	30700-ND5-751	CAP ASSY., noise suppressor	2	—	1,080	• 19	91081-NF4-003	RIVET, blind, 3.2	(8)	—	10
• 3	31800-NH3-000	UNIT ASSY., RC valve control	1	—	18,100	• 20	91301-KR3-003	O-RING, 25.5 x 2.5	(4)	—	105
• 4	43310-NH3-003	HOSE, rear brake	1	—	2,400	21	94050-08000	NUT, flange, 8 mm	(2)	—	20
• 5	52471-NH3-000	PLATE, cushion arm	2	—	1,400	22	95700-06025-00	BOLT, flange, 6 x 25	(1)	—	25
• A	90651-NC8-000	TY-LAP, 3.6 x 281	(1)	—	100	23	95700-08022-00	BOLT, flange, 8 x 22	(2)	—	35
•	06180-NH3-000	EXH CHAMBER SET	1	—	100,000	24	95700-08028-00	BOLT, flange, 8 x 28	(6)	—	35
• 6	18310-NH3-000	CHAMBER COMP., exhaust No.1	(1)	—	35,700	25	96700-06016-07	BOLT, socket, 6 x 16	(6)	—	25
• 7	18311-NH3-000	COLLAR, exhaust chamber	(2)	—	3,000						
• 8	18312-NH3-000	FLANGE, exhaust chamber	(2)	—	1,100						
• 9	18320-NH3-000	CHAMBER COMP., exhaust No.2	(1)	—	35,700						
• 10	18330-NH3-000	SILENCER ASSY., No.1	(1)	—	10,000						
11	18332-KS6-000	SPRING, exhaust pipe	(4)	—	210						
• 12	18333-ND4-760	TUBE, spring	(4)	—	450						
• 13	18335-NF4-003	WOOL, glass	(1)	—	1,100						
• 14	18340-NH3-000	SILENCER ASSY., No.2	(1)	—	10,000						
15	18359-961-000	STAY ASSY., muffler	(2)	—	1,150						
16	19051-KA3-830	RUBBER, radiator mount	(1)	—	90						
17	19052-KA3-830	COLLAR, radiator mount	(1)	—	130						

•OPTIONAL PARTS 1. TRANSMISSION KIT

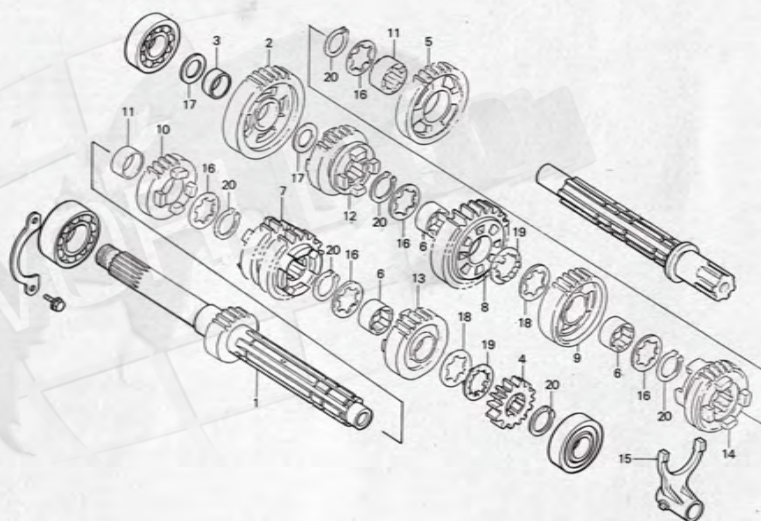

Ref. No.	Parts No.	Description	Reqd. No. ノービス F-III	SP-F	Price (¥)	Ref. No.	Parts No.	Description	Reqd. No. ノービス F-III	SP-F	Price (¥)
•	06120-NH3-000	TRANSMISSION KIT	○	—	108,300	11	23495-KV3-000	COLLAR, 25 x 28 x 9.5	2	—	430
• 1	23210-NH3-000	SHAFT COMP., main (17T)	1	—	9,800	• 12	23501-NF5-000	GEAR, C-5 (29T)	1	—	12,500
•	23210-NH3-810	SHAFT COMP., main P-2 (18T)	(1)	—	9,800	•	23501-NF5-810	GEAR, C-5 P-2 (28T)	(1)	—	12,500
• 2	23421-NF5-000	GEAR, C-1 (38T)	1	—	9,900	• 13	23511-NF5-000	GEAR, M-6 (28T)	1	—	8,800
•	23421-NF5-810	GEAR, C-1 P-2 (38T)	(1)	—	9,900	•	23511-NF5-810	GEAR, M-6 P-2 (29T)	(1)	—	8,800
3	23422-KV3-000	COLLAR, 20 x 23 x 12	1	—	460	• 14	23521-NF5-000	GEAR, C-6 (28T)	1	—	12,400
• 4	23431-NF5-000	GEAR, M-2 (21T)	1	—	3,800	•	23521-NF5-810	GEAR, C-6 P-2 (28T)	(1)	—	12,400
•	23431-NF5-810	GEAR, M-2 P-2 (21T)	(1)	—	3,800	• 15	24213-NF5-000	FORK, L. gear shift	1	—	2,400
•	23431-NF5-820	GEAR, M-2 P-3 (20T)	(1)	—	3,800						
• 5	23441-NF5-000	GEAR, C-2 (34T)	1	—	9,800	16	90451-KE8-000	WASHER, spline 25	5	—	95
•	23441-NF5-810	GEAR, C-2 P-2 (35T)	(1)	—	9,800	17	90454-428-000	WASHER, thrust 20 mm	2	—	95
•	23441-NF5-820	GEAR, C-2 P-3 (35T)	(1)	—	9,800	18	90461-286-000	WASHER, B. thrust 25 mm	2	—	115
6	23442-KV3-000	COLLAR, spline 25 x 10.5	3	—	510	19	90462-323-000	WASHER, lock 25 mm	2	—	95
• 7	23451-NF5-000	GEAR, M-3, M-4 (24T, 26T)	1	—	12,500	20	90601-107-000	CIR-CLIP, 25 mm	6	—	85
•	23451-NF5-810	GEAR, M-3, M-4 P-2 (23T, 25T)	(1)	—	12,500						
• 8	23461-ND5-751	GEAR, C-3 (32T)	1	—	9,400						
•	23461-ND5-861	GEAR, C-3 P-2 (32T)	(1)	—	9,400						
• 9	23481-NF5-000	GEAR, C-4 (30T)	1	—	9,500						
•	23481-NF5-810	GEAR, C-4 (30T)	(1)	—	9,500						
• 10	23491-NF5-000	GEAR, M-5 (27T)	1	—	8,800						
•	23491-NF5-810	GEAR, M-5 (27T)	(1)	—	8,800						

•OPTIONAL PARTS

2. DRY CLUTCH KIT ASSY.

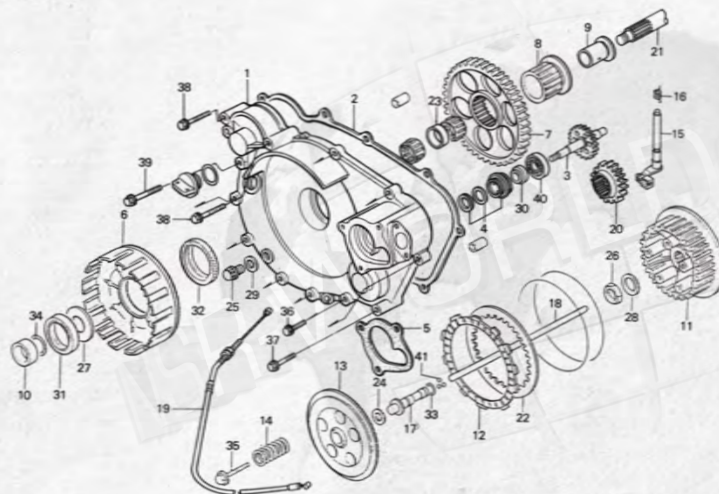

Ref. No.	Parts No.	Description	Reqd. No. ノービス F-III	SP-F	Price (¥)	Ref. No.	Parts No.	Description	Reqd. No. ノービス F-III	SP-F	Price (¥)
•	06130-NH3-000	DRY CLUTCH KIT ASSY.	0	—	108,000	•	19 22870-NH3-000	CABLE COMP., clutch	1	—	1,300
•	1 11331-NH3-000	COVER, R. crank case	1	—	25,000	•	20 23111-NH3-000	GEAR, primary drive	1	—	2,860
•	2 11391-KV3-000	GASKET, R. cover	1	—	320	•	21 23210-NF5-000	SHAFT COMP., main (17T)	1	—	10,900
•	3 19215-NH3-000	SHAFT COMP., water pump	1	—	10,000	•	23210-NF5-810	SHAFT COMP., main (18T)	(1)	—	10,900
•	4 19217-657-023	SEAL, mechanical	1	—	1,550	•	22 23311-200-000	PLATE, A. clutch	5	—	340
•	5 19226-KV3-000	GASKET, water pump cover	1	—	75	•	23 28238-KM4-000	COLLAR, 28.8 mm	1	—	110
•	6 22100-NF5-000	OUTER COMP., clutch	1	—	19,500	•	24 50630-MJ3-000	SHIM, york joint 1.0	1	—	110
•	7 22111-NF5-010	GEAR, primary driven	1	—	11,900	•	50632-MJ3-000	SHIM, york joint 1.4	1	—	110
•	8 22112-NF5-000	COLLAR, clutch outer	1	—	1,600	•	50634-MJ3-000	SHIM, york joint 1.8	1	—	125
•	9 22116-KM4-010	COLLAR, kick starter gear	1	—	580	•	50636-MJ3-000	SHIM, york joint 2.2	1	—	125
•	10 22117-ND5-750	COLLAR, 22 x 30 x 8	1	—	1,500	•	50638-MJ3-000	SHIM, york joint 2.6	1	—	135
•	11 22120-ND5-750	CENTER, clutch	1	—	3,200	•	50640-MJ3-000	SHIM, york joint 3.0	1	—	135
•	12 22201-ND5-750	DISK, clutch friction	6	—	1,300	•	50642-MJ3-000	SHIM, york joint 3.4	1	—	135
•	13 22351-KS6-000	PLATE, clutch presure	1	—	1,750	•	50644-MJ3-000	SHIM, york joint 3.8	1	—	135
•	14 22401-415-000	SPRING, clutch	5	—	135	•	25 90081-NF5-000	BOLT, drain 10 mm	1	—	120
•	15 22810-NH3-000	LEVER COMP., clutch	1	—	2,850	•	26 90235-KA4-000	NUT, hex 18 mm	1	—	185
•	16 22815-NF5-000	SPRING, clutch lever	1	—	650	•	27 90402-ND5-750	WASHER, thrust 32 x 45.5 x 2	1	—	480
•	17 22841-ND5-750	PIECE, lifter joint	1	—	2,100	•	28 90432-428-000	WASHER, lock	1	—	180
•	18 22850-NF5-000	ROD, clutch lifter	1	—	2,150	•	29 90441-425-000	WASHER, sealing 10 mm	1	—	65
						•	30 91201-KM1-005	OIL SEAL, 10 x 20 x 5	1	—	120

•OPTIONAL PARTS 2. DRY CLUTCH KIT ASSY.

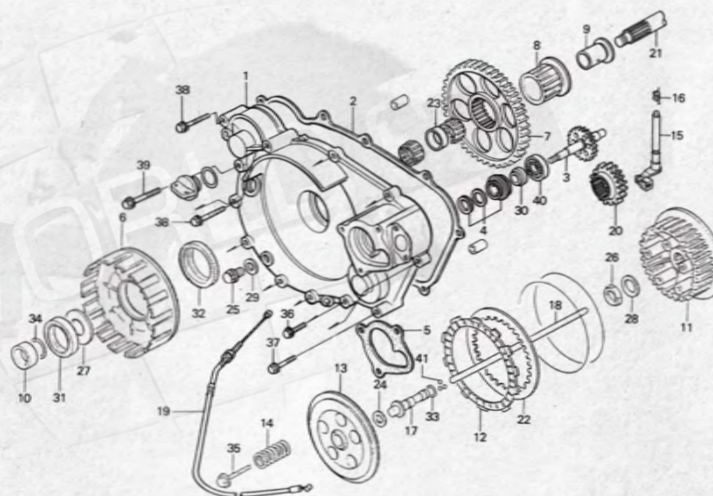

Ref. No.	Parts No.	Description	Reqd. No. ノービス F-III	SP-F	Price (¥)	Ref. No.	Parts No.	Description	Reqd. No. ノービス F-III	SP-F	Price (¥)
31	91264-415-003	OIL SEAL, 30 x 47 x 7	1	—	320						
32	91271-MB0-003	OIL SEAL, 47 x 56 x 7	1	—	300						
33	91304-GE0-000	O-RING, 7.8 x 1.7	1	—	45						
34	91359-415-300	O-RING, 22 x 1.7	1	—	95						
35	93404-06016-08	BOLT, washer, 6 x 16	5	—	20						
36	96001-06028-00	BOLT, flange, SH, 6 x 28	8	—	35						
37	96001-06035-00	BOLT, flange, SH, 6 x 35	1	—	35						
38	96001-06055-00	BOLT, flange, SH, 6 x 55	2	—	35						
39	96001-06060-00	BOLT, flange, SH, 6 x 60	1	—	35						
40	96100-60000-00	BEARING, ball radial, 6000	1	—	300						
41	96211-06000	BALL, steel, 6	3	—	10						

DOWNLOADED FROM NSR-WORLD.COM
REPRODUCED WITH THE PERMISSION OF HONDA MOTOR COMPANY
FOR USE ON NSR-WORLD.COM & nsr250.net ONLY.

•OPTIONAL PARTS

2. DRY CLUTCH KIT ASSY.

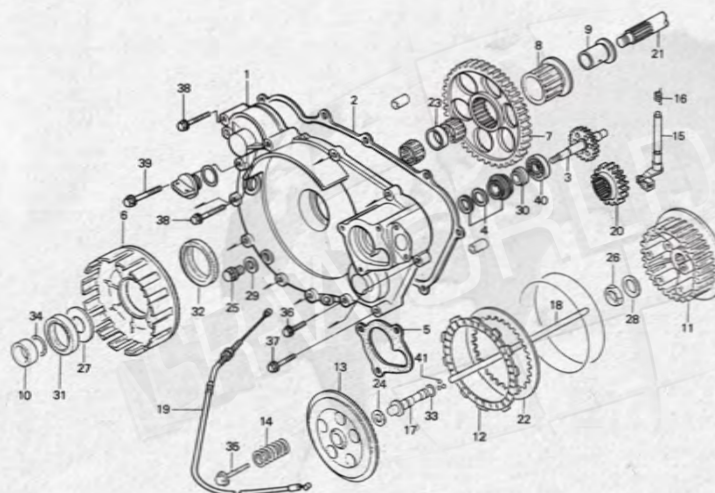

Ref. No.	Parts No.	Description	Reqd. No. ノービス F-III	SP-F	Price (¥)	Ref. No.	Parts No.	Description	Reqd. No. ノービス F-III	SP-F	Price (¥)
•	06130-NH3-000	DRY CLUTCH KIT ASSY.	0	—	108,000	•	19 22870-NH3-000	CABLE COMP., clutch	1	—	1,300
•	1 11331-NH3-000	COVER, R. crank case	1	—	25,000	•	20 23111-NH3-000	GEAR, primary drive	1	—	2,860
•	2 11391-KV3-000	GASKET, R. cover	1	—	320	•	21 23210-NF5-000	SHAFT COMP., main (17T)	1	—	10,900
•	3 19215-NH3-000	SHAFT COMP., water pump	1	—	10,000	•	23210-NF5-810	SHAFT COMP., main (18T)	(1)	—	10,900
•	4 19217-657-023	SEAL, mechanical	1	—	1,550	•	22 23311-200-000	PLATE, A. clutch	5	—	340
•	5 19226-KV3-000	GASKET, water pump cover	1	—	75	•	23 28238-KM4-000	COLLAR, 28.8 mm	1	—	110
•	6 22100-NF5-000	OUTER COMP., clutch	1	—	19,500	•	24 50630-MJ3-000	SHIM, york joint 1.0	1	—	110
•	7 22111-NF5-010	GEAR, primary driven	1	—	11,900	•	50632-MJ3-000	SHIM, york joint 1.4	1	—	110
•	8 22112-NF5-000	COLLAR, clutch outer	1	—	1,600	•	50634-MJ3-000	SHIM, york joint 1.8	1	—	125
•	9 22116-KM4-010	COLLAR, kick starter gear	1	—	580	•	50636-MJ3-000	SHIM, york joint 2.2	1	—	125
•	10 22117-ND5-750	COLLAR, 22 x 30 x 8	1	—	1,500	•	50638-MJ3-000	SHIM, york joint 2.6	1	—	135
•	11 22120-ND5-750	CENTER, clutch	1	—	3,200	•	50640-MJ3-000	SHIM, york joint 3.0	1	—	135
•	12 22201-ND5-750	DISK, clutch friction	6	—	1,300	•	50642-MJ3-000	SHIM, york joint 3.4	1	—	135
•	13 22351-KS6-000	PLATE, clutch pressure	1	—	1,750	•	50644-MJ3-000	SHIM, york joint 3.8	1	—	135
•	14 22401-415-000	SPRING, clutch	5	—	135	•	25 90081-NF5-000	BOLT, drain 10 mm	1	—	120
•	15 22810-NH3-000	LEVER COMP., clutch	1	—	2,850	•	26 90235-KA4-000	NUT, hex 18 mm	1	—	185
•	16 22815-NF5-000	SPRING, clutch lever	1	—	650	•	27 90402-ND5-750	WASHER, thrust 32 x 45.5 x 2	1	—	480
•	17 22841-ND5-750	PIECE, lifter joint	1	—	2,100	•	28 90432-428-000	WASHER, lock	1	—	180
•	18 22850-NF5-000	ROD, clutch lifter	1	—	2,150	•	29 90441-425-000	WASHER, sealing 10 mm	1	—	65
						•	30 91201-KM1-005	OIL SEAL, 10 x 20 x 5	1	—	120

•OPTIONAL PARTS 3. OIL CATCH TANK SET

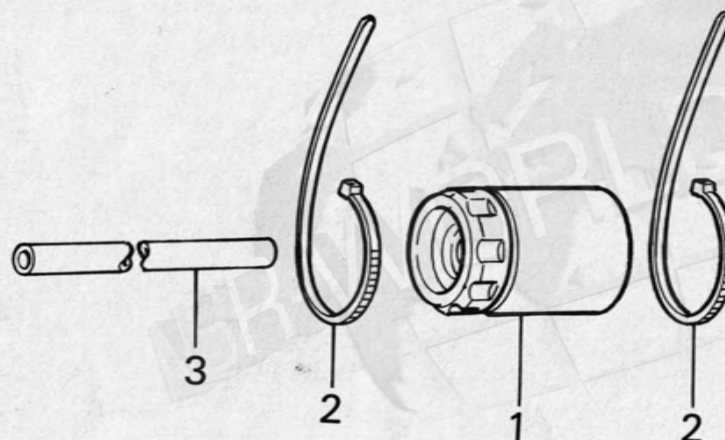

Ref. No.	Parts No.	Description	Reqd. No. ノーマル F-III	SP-F	Price (¥)	Ref. No.	Parts No.	Description	Reqd. No. ノーマル F-III	SP-F	Price (¥)
•	06170-NH3-000	TANK SET, oil catch	○	○	850						
• 1	19601-ND4-750	TANK, catch	1	1	600						
• 2	90651-NC8-000	TY-LAP, 3.6 x 281	2	2	100						
• 3	95003-14040-10	V-TUBE, 6 x 9 x 400	1	1	50						

DOWNLOADED FROM NSR-WORLD.COM
REPRODUCED WITH THE PERMISSION OF HONDA MOTOR COMPANY
FOR USE ON NSR-WORLD.COM & nsr250.net ONLY.

•OPTIONAL PARTS 4. RADIATOR SET

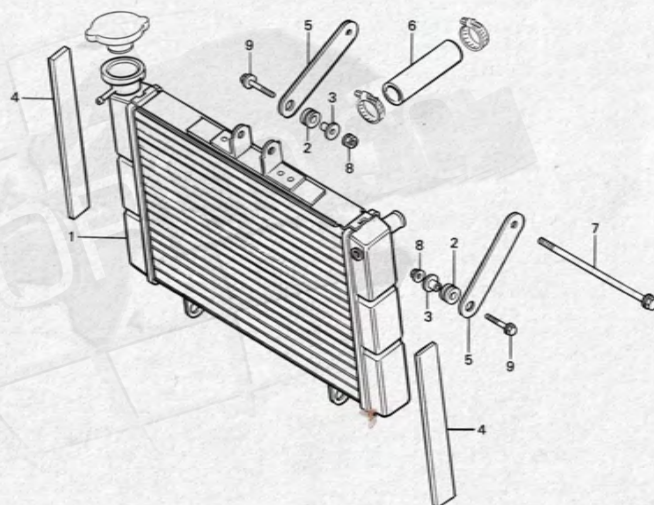

Ref. No.	Parts No.	Description	Reqd. No. ノービス F-III	SP-F	Price (¥)	Ref. No.	Parts No.	Description	Reqd. No. ノービス F-III	SP-F	Price (¥)
•	06190-NH3-000	RADIATOR SET	○	○	36,200						
•	1 19010-NH3-003	RADIATOR COMP.	1	1	35,600						
•	2 19051-KA3-830	RUBBER, radiator mount	2	2	90						
•	3 19052-KA3-830	COLLAR, radiator mount	2	2	130						
•	4 19112-NH3-000	SPONGE, radiator	1	1	200						
•	5 19115-NH3-000	STAY, radiator lower	2	2	350						
•	6 19507-NH3-000	HOSE, radiator lower	1	1	500						
•	7 90102-KV0-000	BOLT, engine hanger 10 x 270	1	1	350						
•	8 90301-473-003	NUT, U. 6 mm	2	2	135						
•	9 95801-06025-00	BOLT, flange 6 x 25	2	2	25						

DOWNLOADED FROM NSR-WORLD.COM
REPRODUCED WITH THE PERMISSION OF HONDA MOTOR COMPANY
FOR USE ON NSR-WORLD.COM & nsr250.net ONLY.

•OPTIONAL PARTS 5. CARBURETOR BOX SET

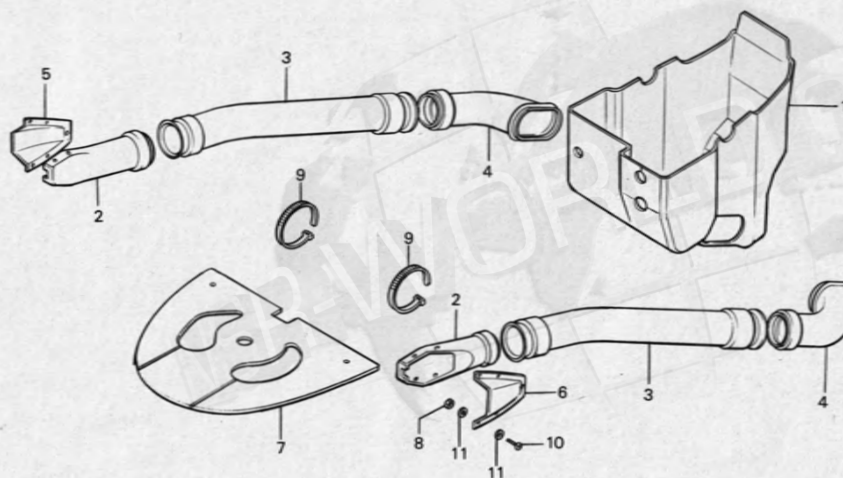

Ref. No.	Parts No.	Description	Reqd. No. ノービス F-III SP-F		Price (¥)	Ref. No.	Parts No.	Description	Reqd. No. ノービス F-III SP-F		Price (¥)
•	06210-NH3-000	CARBURETOR BOX SET	O	O	23,200						
•	1 17210-NH3-000	BOX, carb.	1	1	9,100						
•	2 17220-NH3-000	HOSE, carb. box A	2	2	600						
•	3 17230-NH3-000	HOSE, carb. box B	2	2	600						
•	4 17240-NH3-000	HOSE, carb. box C	2	2	600						
•	5 17250-NH3-000	DUCT, R. air intake	1	1	2,000						
•	6 17251-NH3-000	DUCT, L. air intake	1	1	2,000						
•	7 17260-NH3-000	COVER, radiator upper	1	1	3,500						
•	8 90310-NF4-000	NUT, self lock 3 mm	18	18	200						
•	9 90652-ND5-000	TY-LAP, 2.4 x 92	2	2	60						
10	93500-03012-0A	SCREW, pan, 3 x 12	18	18	10						
11	94101-03000	WASHER, plain, 3 mm	36	36	10						

•OPTIONAL PARTS 6. CHOKE CABLE SET



Ref. No.	Parts No.	Description	Reqd. No. ノービス F-III	SP-F	Price (¥)	Ref. No.	Parts No.	Description	Reqd. No. ノービス F-III	SP-F	Price (¥)
•	06220-NH3-000	CHOKE CABLE SET	0	0	2,260						
1	17950-KB1-710	CABLE COMP., choke	1	1	910						
•	2 17966-NH3-000	BRACKET, choke cable	1	1	1,300						
3	95701-08014-00	BOLT, flange 8 x 14	2	2	25						

DOWNLOADED FROM NSR-WORLD.COM
REPRODUCED WITH THE PERMISSION OF HONDA MOTOR COMPANY
FOR USE ON NSR-WORLD.COM & nsr250.net ONLY.

•OPTIONAL PARTS 7. WATER TEMP METER SET

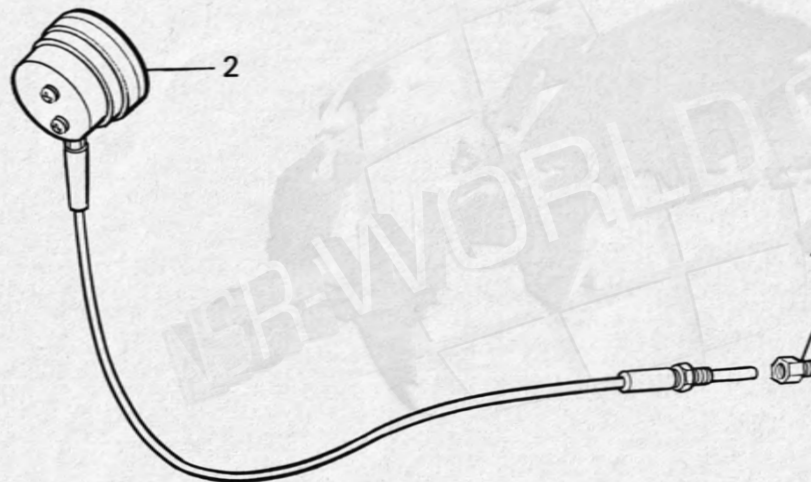

Ref. No.	Parts No.	Description	Reqd. No. ノービス F-III SP-F		Price (¥)	Ref. No.	Parts No.	Description	Reqd. No. ノービス F-III SP-F		Price (¥)
•	06310-NH3-000	WATER TEMP METER SET	○	○	5,160						
• 1	19301-NC7-000	ADAPTOR, water temp sensor	1	1	360						
• 2	37460-NF4-020	METER ASSY., water temp	1	1	4,800						

DOWNLOADED FROM NSR-WORLD.COM
REPRODUCED WITH THE PERMISSION OF HONDA MOTOR COMPANY
FOR USE ON NSR-WORLD.COM & nsr250.net ONLY.

•OPTIONAL PARTS 8. METER SET

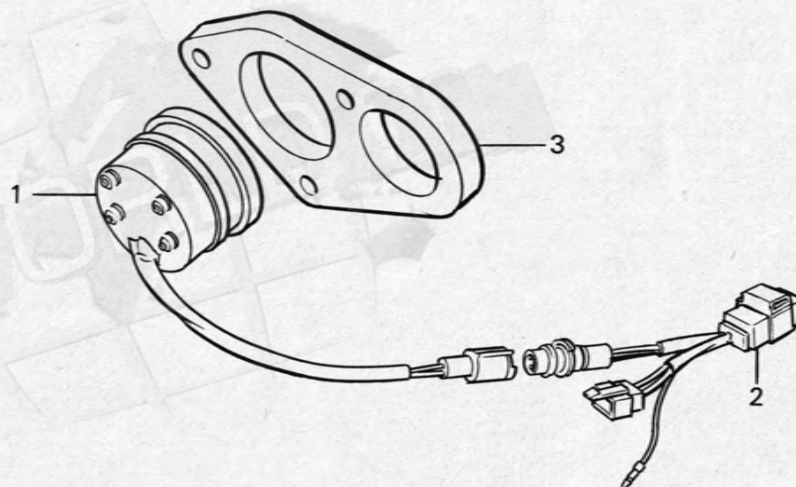

Ref. No.	Parts No.	Description	Reqd. No. ノービス F-III	SP-F	Price (¥)	Ref. No.	Parts No.	Description	Reqd. No. ノービス F-III	SP-F	Price (¥)
•	06320-NH3-000	METER SET	○	○	28,200						
•	1 37250-NF4-008	TACHOMETER ASSY.	1	—	21,000						
•	2 37256-NH3-000	TACHO CONVERTER	1	—	7,800						
•	3 50815-NF4-000	PANEL, meter	1	—	800						
•	90651-ND5-000	TY-LAP, 2.4 x 92	(1)	—	60						

DOWNLOADED FROM NSR-WORLD.COM
REPRODUCED WITH THE PERMISSION OF HONDA MOTOR COMPANY
FOR USE ON NSR-WORLD.COM & nsr250.net ONLY.

•OPTIONAL PARTS
9. SPRINT ACG SET

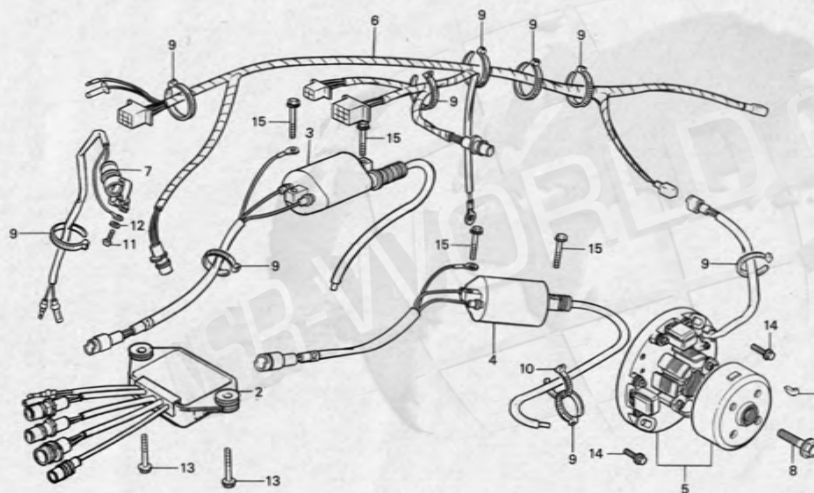

Ref. No.	Parts No.	Description	Reqd. No. ノービス F-III	SP-F	Price (¥)
•	06330-NH3-000	SPRINT ACG SET クランクケース追加加工	○	—	84,700
•	1 13332-NF5-000	KEY, woodruff special	1	—	200
•	2 30400-NF5-003	CD1 UNIT ASSY.	1	—	36,000
•	3 30510-NH3-700	COIL COMP, ignition A	1	—	4,200
•	4 30520-NH3-700	COIL COMP, ignition B	1	—	4,200
•	5 31100-NF5-003	AC GEN ASSY.	1	—	40,000
•	6 32100-NH3-000	HARNESS, wire	(1)	—	7,600
•	32100-NH3-700	HARNESS, wire	1	—	2,200
		Ref.No. 2.5取付時使用			
•	7 35130-ND4-750	SWITCH ASSY., kill	1	—	1,100
•	8 90002-KM4-010	BOLT, flange, 10 x 30	1	—	105
•	9 90651-NC8-000	TY-LAP 3.6 x 281	9	—	100
•	10 90652-ND5-000	TY-LAP 2.4 x 92	1	—	60
11	93500-04012-0A	SCREW, pan 4 x 12	(1)	—	10
		キルスイッチ構成部品			
12	94111-04000	WASHER, spring, 4 mm	(1)	—	10
		キルスイッチ構成部品			
13	95700-06025-00	BOLT, flange, 6 x 25	2	—	25

クランクケース追加加工図

Downloaded from NSR-WORLD.COM
REPRODUCED WITH THE PERMISSION OF HONDA MOTOR CO., LTD.
FOR USE ON NSR-WORLD.COM & nsr2.com ONLY.

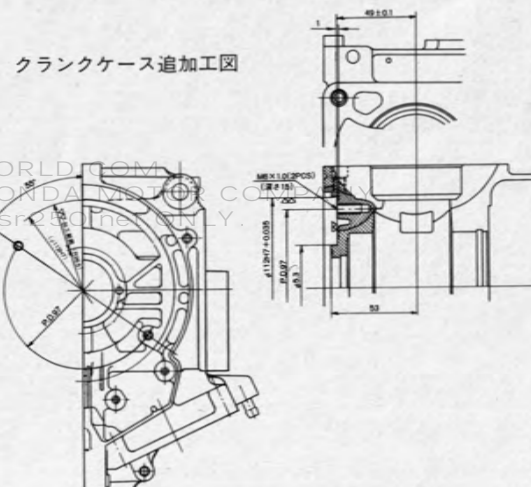

•OPTIONAL PARTS 10. FRONT BRAKE HOSE SET

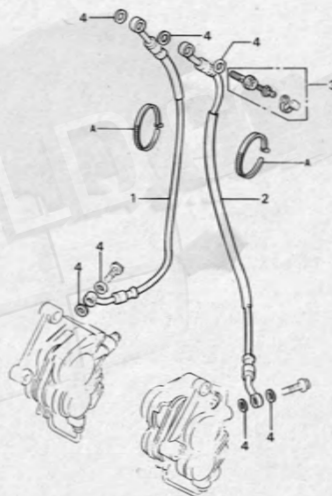

Ref. No.	Parts No.	Description	Reqd. No. ノーマル SP-F F-III		Price (¥)	Ref. No.	Parts No.	Description	Reqd. No. ノーマル SP-F F-III		Price (¥)
•	06410-NH3-000	FRONT BRAKE HOSE SET	○	○	8,200						
• 1	45124-NH3-003	HOSE, R. front brake	1	1	3,200						
• 2	45125-NH3-003	HOSE, L. front brake	1	1	3,200						
• 3	45530-NF5-000	BOLT ASSY., oil breeder	1	1	1,000						
• 4	46472-568-000	PACKING, oil bolt	7	7	90						
• A	90651-NC8-000	TY-LAP, 3.6 x 281	2	2	100						

DOWNLOADED FROM NSR-WORLD.COM
REPRODUCED WITH THE PERMISSION OF HONDA MOTOR COMPANY
FOR USE ON NSR-WORLD.COM & nsr250.net ONLY.

•OPTIONAL PARTS 11. BACK STEP SET

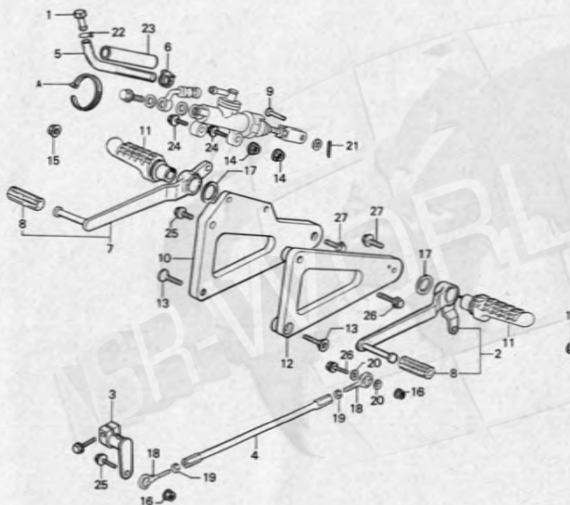

Ref. No.	Parts No.	Description	Reqd. No. F-III	SP-F	Price (¥)	Ref. No.	Parts No.	Description	Reqd. No. F-III	SP-F	Price (¥)
	06500-NH3-000	BACK STEP SET	○	○	44,300	• 18	91048-NC5-000	END, rod, 8 mm	2	2	660
		リジットマウント				19	94002-08200-0S	NUT, hex 8 mm	2	2	15
1	17370-419-700	PLUG, breather tube	1	1	100	20	94101-08000	WASHER, plain 8 mm	2	2	10
• 2	24700-NH3-000	PEDAL ASSY., gear change	1	1	8,900	21	94201-20150	PIN split 2.0 x 15	1	1	10
• 3	24710-NH3-000	ARM, gear change	1	1	2,800	22	95002-02120	CLIP, B12. tube	1	1	20
• 4	24730-NH3-000	ROD, gear change	1	1	1,970	23	95003-45120-10	V-TUBE 14 x 18 x 120	1	1	450
• 5	43503-ND4-750	V-TUBE, 9 x 13 x 200	1	1	100	24	95801-06028-00	BOLT, flange, 6 x 28	2	2	25
• 6	43541-ND5-750	CLAMP	1	1	240	25	95801-08025-00	BOLT, flange, 8 x 25	2	2	35
• 7	46500-NH3-000	PEDAL ASSY., rear brake	1	1	9,000	26	95801-08030-00	BOLT, flange, 8 x 30	2	2	35
• 8	46501-ND4-750	RUBBER, pedal	(2)	(2)	360	27	95801-10050-00	BOLT, flange, 10 x 50	2	2	45
• 9	46502-NH3-000	PIN, brake rod	1	1	100	• A	90651-NC8-000	TY-LAP, 3.6 x 281	1	1	100
• 10	50600-NH3-000	HOLDER, R. step	1	1	5,000						
• 11	50610-ND5-750	ARM COMP., step	2	2	5,100						
• 12	50700-NH3-000	HOLDER, L. step	1	1	5,000						
• 13	90101-NH3-000	SCREW, socket 8 x 28	2	2	100						
14	90301-473-003	NUT, U. 6 mm	2	2	135						
15	90304-GA6-003	NUT, axle	2	2	85						
16	90309-428-731	NUT, flange 8 mm	2	2	115						
17	90407-HB3-000	WASHER, 16.2 mm	2	2	85						

•OPTIONAL PARTS 12. STEERING DAMPER SET

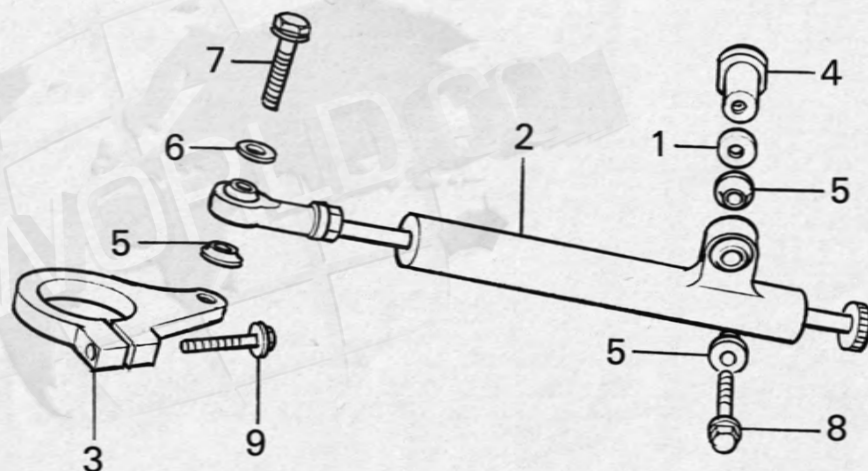

Ref. No.	Parts No.	Description	Reqd. No. ノービス F-III	SP-F	Price (¥)	Ref. No.	Parts No.	Description	Reqd. No. ノービス F-III	SP-F	Price (¥)
•	06530-NH3-000	STEERING DAMBER SET	○	○	22,000						
		フレームにφ15穴開け必要									
1	28302-369-000	COLLAR, kick stopper	1	1	60						
•	2	53700-NF5-004	DAMPER ASSY, steering	1	1	16,500					
•	3	53710-NH3-000	STAY, steering damper	1	1	3,500					
•	4	53711-NH3-000	NUT, steering damper	1	1	550					
•	5	53713-NC8-000	SPACER, steering damper	3	3	540					
6	94102-08000	WASHER, plain 8 mm	1	1	10						
7	95801-08030-00	BOLT, flange 8 x 30	1	1	35						
8	95801-08045-00	BOLT, flange 8 x 45	1	1	35						
9	96001-06028-00	BOLT, flange SH, 6 x 28	1	1	35						

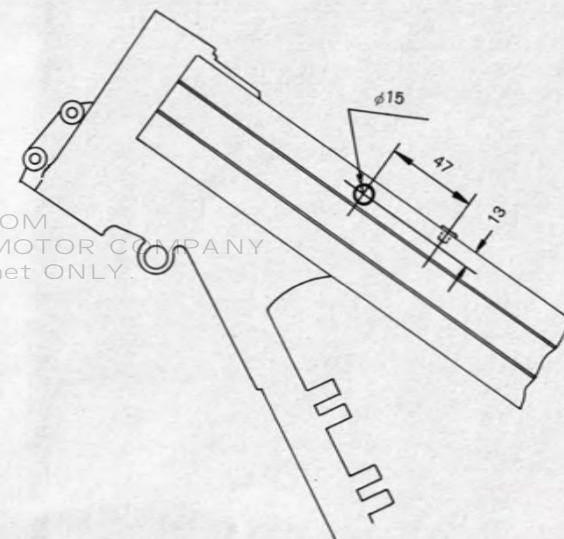

•OPTIONAL PARTS

13. COWLING SET

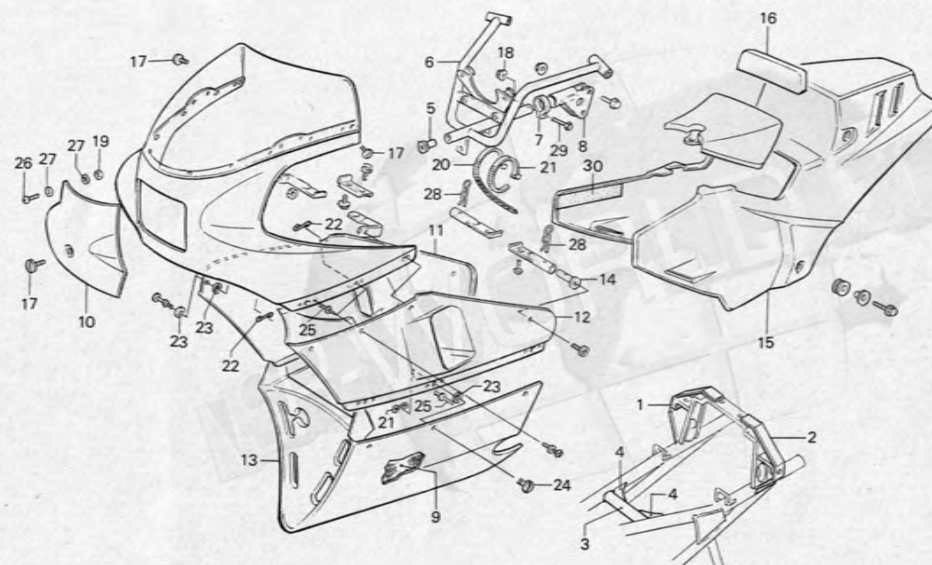

Ref. No.	Parts No.	Description	Reqd. No. ノービス F-III	SP-F	Price (¥)	Ref. No.	Parts No.	Description	Reqd. No. ノービス F-III	SP-F	Price (¥)
•	06640-NH3-000	COWLING SET	0	—	126,000	•	18 90301-473-003	NUT, U. 6 mm	1	—	135
•	1 50201-NH3-300	STIFF, R.	1	(1)	1,500	•	19 90310-NF4-000	NUT, self lock 3 mm	4	(4)	200
•	2 50202-NH3-300	STIFF, L.	1	(1)	1,500	•	20 90651-NC8-000	TY-LAP 3.6 x 281	1	—	100
•	3 50203-NH3-300	PIPE, seat rail cross	1	(1)	600	•	21 90652-ND5-000	TY-LAP 2.4 x 92	1	—	60
•	4 50204-NH3-300	GUSSET, cross pipe	2	(2)	250	•	22 90653-NC8-000	SPRING, fastner 35	(6)	—	60
•	5 50803-ND4-750	NUT, cowl stay	1	—	360	•	23 90654-NC8-000	GROMMET, fastner	(6)	—	10
•	6 50810-NH3-000	STAY COMP., front cowl	1	—	14,000	•	24 90655-NC8-000	STUD, fastner	(6)	—	210
•	7 50811-ND4-750	BAND, D=25.4	1	—	600	•	25 91080-NC8-300	RIVET, 3.2 x 6.4	(12)	—	10
•	8 50815-NH3-000	HOLDER, cowling stay	1	—	6,500	•	26 93500-03012-0A	SCREW, pan, 3 x 12	4	(4)	10
•	9 64109-ND5-750	SHEET, heat proof	(2)	—	600	•	27 94101-03000	WASHER, plain 3 mm	8	(8)	10
•	10 64201-NH3-000	PLATE, front number	1	(1)	4,700	•	28 94252-14000	PIN, lock, 14 mm	2	—	40
•	11 64220-NH3-000	COWL, front side R	1	—	14,500	•	29 96000-06022-00	BOLT, flange, SH 6 x 22	1	—	35
•	12 64230-NH3-000	COWL, front side L	1	—	14,500	•	30 77211-NH3-300	RUBBER, seat cowl	(2)	(2)	200
•	13 64300-NH3-000	COWL, lower	1	—	29,000						
•	14 64533-NH3-000	PIN, lower cowl set	2	—	1,200						
•	15 77210-NH3-000	COWL, seat	1	(1)	38,800						
•	16 77230-NH3-300	RUBBER, seat back	1	(1)	1,000						
•	17 90106-NF4-000	BOLT, cowl set 6 x 12	3	—	250						

14. OTHER PARTS

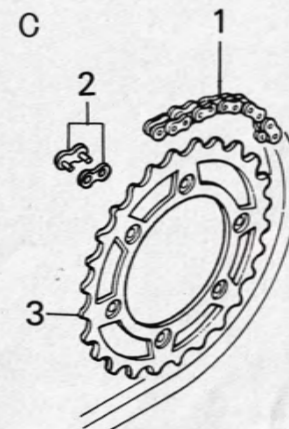
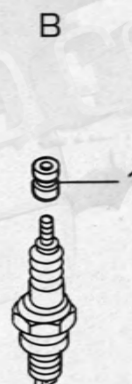
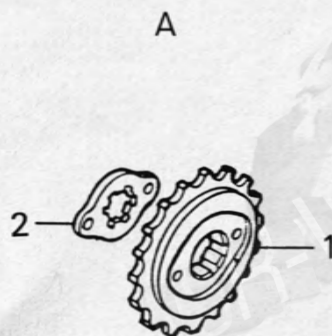

Ref. No.	Parts No.	Description	Reqd. No. ノーマル F-III	SP-F	Price (¥)	Ref. No.	Parts No.	Description	Reqd. No. ノーマル F-III	SP-F	Price (¥)
<ENGINE>											
• A1	23801-KE8-000	SPROCKET, drive 14T	1	1	1,750	•	41202-NH3-000	SPROCKET, final driven, 38T	1	1	6,000
•	23801-NH3-000	SPROCKET, drive 15T	1	1	2,900	•	41203-NH3-000	SPROCKET, final driven, 39T	1	1	6,000
•	23802-NH3-000	SPROCKET, drive 16T	1	1	2,900	•	41204-NH3-000	SPROCKET, final driven, 40T	1	1	6,000
2	95014-91200	PLATE A2 fixing	1	1	45						
		(14Tのスプロケットのみ使用)									
• B1	31910-NF4-000	NUT, spark plug	—	2	200						
• C1	40520-NF2-003	CHAIN, drive (520TR-106L)	1	1	9,200						
•	40530-NE5-003	CHAIN, drive (520VS-108L)	1	1	9,200						
•	40530-NF5-003	CHAIN, drive (520TZ-108L)	1	1	9,600						
•	40530-NF5-004	CHAIN, drive (520TR-108L)	1	1	9,600						
•	40540-NF2-003	CHAIN, drive (520VS-106L)	1	1	9,200						
• 2	40531-NE5-000	JOINT, RJ. drive chain	(1)	(1)	300						
		(DID520VS-CLIP)									
•	40532-NE5-000	JOINT, XJ. drive chain	(1)	(1)	360						
		(DID520VS-STAKE)									
•	40536-ND5-751	JOINT, XJ. drive chain	(1)	(1)	360						
		(DID520TR-STAKE)									
•	40536-ND5-752	JOINT, drive chain	(1)	(1)	360						
• 3	41201-NF9-000	SPROCKET, final driven, 41T	1	1	6,000						
•	41201-NH3-000	SPROCKET, final driven, 37T	1	1	6,000						
•	41202-NF9-000	SPROCKET, final driven, 42T	1	1	6,000						

14. OTHER PARTS

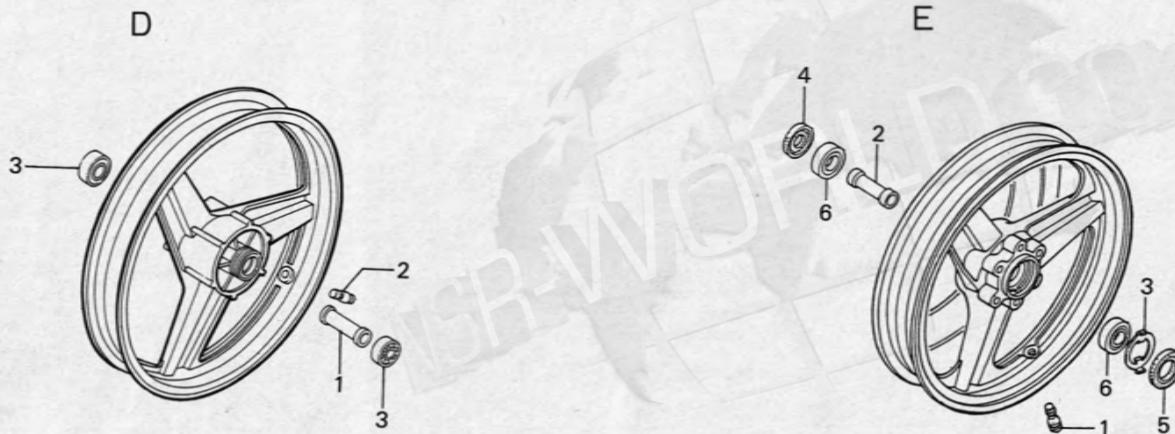

Ref. No.	Parts No.	Description	Reqd. No. ノービス F-III	SP-F	Price (¥)	Ref. No.	Parts No.	Description	Reqd. No. ノービス F-III	SP-F	Price (¥)
D	42600-NH3-000	WHEEL ASSY., rear 3.50 x 18	0	—	73,000						
1	42620-KV3-000	COLLAR, A. rear wheel distance	1	—	430						
2	42753-ML0-005	VALVE, rim (YRC)	1	—	250						
	42753-ML7-004	VALVE, rim (DUN)	1	—	250						
3	96150-60040-10	BEARING, ball radial 6004 uu	2	—	640						
• E	44600-NH3-000	WHEEL ASSY., front 3.00 x 17	0	—	71,000						
1	42753-ML0-005	VALVE, rim (YRC)	1	—	250						
	42753-ML7-004	VALVE, rim (DUN)	1	—	250						
2	44620-KT8-000	COLLAR, front axle distance	1	—	300						
3	44680-ML7-005	RETAINER, gear box	1	—	125						
4	91257-KA3-711	DUST SEAL, 28 x 42 x 8	1	—	220						
	91257-KA3-712	DUST SEAL, 28 x 42 x 8	1	—	220						
5	91258-ML7-003	DUST SEAL, 45 x 55 x 5	1	—	250						
	91258-ML7-004	DUST SEAL, 45 x 55 x 5	1	—	250						
6	96150-60040-10	BEARING, ball radial 6004 uu	2	—	640						

14. OTHER PARTS

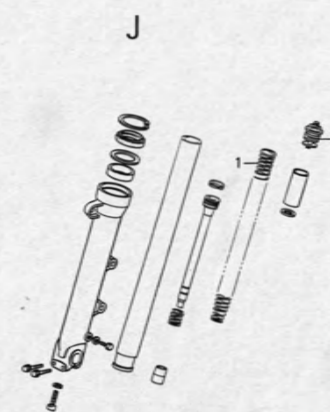
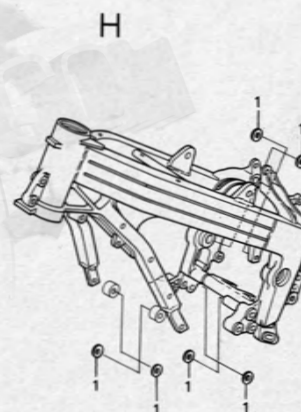
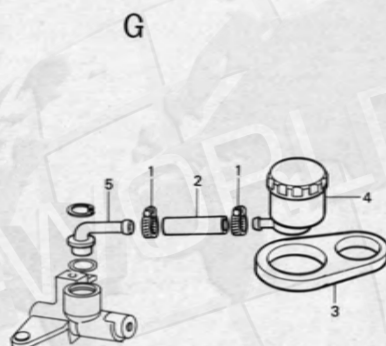

Ref. No.	Parts No.	Description	Reqd. No. ノービス F-III	SP-F	Price (¥)	Ref. No.	Parts No.	Description	Reqd. No. ノービス F-III	SP-F	Price (¥)
F1	43511-KS6-701	CUP COMP., master cylinder	1	—	500	J1	51401-NH3-003	SPRING, front cushion	2	—	3,800
2	43513-KS6-701	CAP, master cylinder	1	—	250	• 2	51450-NF3-003	BOLT, ASSY., front fork	2	—	5,500
3	45518-GM9-711	PLATE, diaphragm	1	—	110						
4	45520-GM9-711	DIAPHRAGM	1	—	220						
• G1	43541-ND5-750	CLAMP	2	—	240						
• 2	45501-NH3-000	V-TUBE, 9 x 13 x 20	1	—	100						
• 3	45510-NF5-000	STAY, front master cylinder tank	1	—	200						
• 4	45520-NF5-003	TANK ASSY., front master cylinder	1	—	2,500						
• 5	45502-NH3-000	CONNECTOR	1	—	200						
H	ENGINE MOUNT SHIM										
1	90405-GE0-000	WASHER, thrust (10.2 x 22 x 1)	N	—	70						
	90460-KJ1-000	WASHER, thrust 10.2 mm (10.2 x 22 x 0.5).....	N	—	60						
•	90531-NC8-000	WASHER, front master cylinder (10.2 x 18 x 0.3).....	N	—	690						

MEMO



DOWNLOADED FROM NSR-WORLD.COM
REPRODUCED WITH THE PERMISSION OF HONDA MOTOR COMPANY
FOR USE ON NSR-WORLD.COM & nsr250.net ONLY.

MEMO



DOWNLOADED FROM NSR-WORLD.COM
REPRODUCED WITH THE PERMISSION OF HONDA MOTOR COMPANY
FOR USE ON NSR-WORLD.COM & nsr250.net ONLY.

RACING SERVICE

HRC指定レーシングサービスショップ一覧

レーシングマシンのセッティングやメンテナンス、パーツが欲しい...etc.

レースに関することなら、なんでもHRC指定レーシングサービスショップにお気軽にご相談ください

現在、全国に41店舗。いずれもレース経験豊富なお店です

- ① オートランド札幌(北海道) ☎011-892-3323 札幌市白石区厚別町旭町433-134
- ② ホンダウイングトムズ(北海道) ☎0136-22-1008 虻田郡倶知安町北一条西2-17
- ③ ホンダウイング荘内(山形県) ☎0234-92-3838 酒田市大字広野字中通り32-1
- ④ 三愛バイクセンター(新潟県) ☎0256-34-8325 三条市下須頃24
- ⑤ ホンダウイング高橋(新潟県) ☎02579-2-0778 北魚沼郡小出町虫野113-3
- ⑥ ビックフォー小松島(宮城県) ☎0222-71-2181 泉市松森字中通43-2
- ⑦ 株クルーズ(宮城県) ☎0224-62-0671 角田市角田字町152
- ⑧ モトビットマックス(福島県) ☎0243-33-2455 安達郡本宮町栄田147
- ⑨ モトショップ ハマ(長野県) ☎0263-32-5231 松本市沢村3-1-12
- ⑩ ワールド筑波(茨城県) ☎0296-49-3138 八千代町大字栗山字氏神698-3
- ⑪ モトライフポイントユーギア(千葉県) ☎0473-61-1051 松戸市松戸1051-4
- ⑫ ホンダスポーツモトバム(東京都) ☎03-831-4265 台東区台東4-13-23
- ⑬ オートショップスガハラ(東京都) ☎03-914-7500 北区王子3-20-2
- ⑭ マン島スポーツ(東京都) ☎03-750-3811 大田区千鳥町2-11-3
- ⑮ ボールポジション(東京都) ☎0423-75-3083 多摩市貝取607-3
- ⑯ RPM(東京都) ☎0425-81-0421 日野市日野669-2
- ⑰ ホンダショップ和光(埼玉県) ☎0484-61-7478 和光市本町20-17
- ⑱ ホンダエンデュランス(埼玉県) ☎0492-22-7770 川越市山田1667-1
- ⑲ モトウイング我來(埼玉県) ☎0429-54-7467 狭山市下奥富613
- ⑳ ホンダショップ成田(神奈川県) ☎044-411-4171 川崎市中原区中丸子439
- ㉑ ホンダスーパーウイング丸山(神奈川県) ☎0463-34-0651 中郡大磯町高麗3-2-39
- ㉒ RSヤマダ(愛知県) ☎0578-66-5186 岩倉市中本町葭原7-1
- ㉓ 中部ミスターバイク(愛知県) ☎0568-84-5251 春日井市端穂通8-15-1
- ㉔ ラ・モト高阪(愛知県) ☎05679-5-9991 海部郡蟹江町源氏1-6
- ㉕ ザ バイク イサカ(三重県) ☎0593-83-3470 鈴鹿市稲生町7990-15
- ㉖ ホンダワールド(三重県) ☎0593-78-1455 鈴鹿市住吉町6786
- ㉗ 三谷モータースポーツショップ(三重県) ☎05983-8-2222 多気郡多気町四正田324
- ㉘ バイクショップトライ(岐阜県) ☎0583-83-7722 各務原市那加信長町1-283

- ㉙ ホンダレッドシティー(富山県) ☎0765-24-3121 魚津市本江2535
- ㉚ バイクショップトムス(京都府) ☎075-491-5552 京都市北区紫野下島町1-3
- ㉛ スーパーネッシーコタニ(京都府) ☎07712-4-6308 亀岡市篠町空殿林20-6
- ㉜ スーパーモンキー(大阪府) ☎0729-64-3177 東大阪市玉串町元町2-8-27
- ㉝ RSタイチ(大阪府) ☎0720-74-5315 大東市中垣内3-1-25
- ㉞ サイクルワールド(兵庫県) ☎078-928-6644 神戸市西区森友4-13
- ㉟ ミネモーターサイクル(兵庫県) ☎078-743-5440 神戸市須磨区妙法寺地子田1038-8
- ㊱ モトワールド岡山(岡山県) ☎08695-5-2519 赤磐郡山陽町河本1076-5
- ㊲ M. Sファッションパドック(岡山県) ☎0868-28-3191 津山市二宮662
- ㊳ 梅本商会(岡山県) ☎0862-32-0011 岡山市南中央町12-9
- ㊴ ホンダアロー(徳島県) ☎0886-65-5330 徳島市川内町平石夷町250-2
- ㊵ ホンダショップライブ(福岡県) ☎093-922-8914 北九州市小倉北区片野新町1-1-1
- ㊶ ホンダショップ高武(福岡県) ☎092-781-2682 福岡市中央区赤坂2-5-54



〒352 埼玉県新座市野火止8-18-4 ㈱ホンダ・レーシング
TEL 0484-77-9538 0484-77-9539