

MiraAdapter For HDTV

Spec :

MiraAdapter , Use it with Phone or Pad and PC to enjoy your favorite local or online entertainment easily on your big HDTV or projector in up to 1080p HD display--movies, TV shows, music, video audio, photo and more from browser, youtube and etc. No more only oneself enjoy appliances by small screens and tiny speakers. Use it, so you can share the happiness with your family or friend together on your big HDTV or projector. Enjoying you love now on your TV or projector.

Start Screen

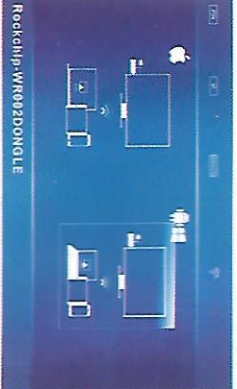

Hardware Installation

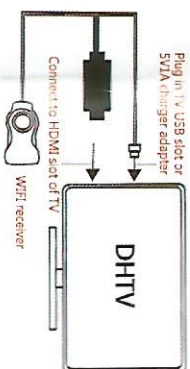

MiraAdapter for I-O-S :

*Supports iOS7 Above
*Compatible with IP/S5/S5/P6/P6/P6/P7/P7/
Pod touch and Pad
*Supports 480*320 136 640 P for phone
*Supports 1024*768 2048*1536 P for pad
*Needed the storage at least 40 M for the free space

Device connection :

For the first time setting --
1. "Setting" - "WLAN" choose "DONGLE-*****" and enter
(PIN) : 12345678



2. Enter IP:192.168.49.1 on Safari browser to set WIFI, please link to your home WIFI too.



2. Enter IP:192.168.49.1 on browser to set WIFI, please link to your home WIFI too.

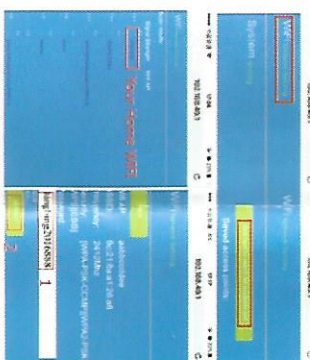
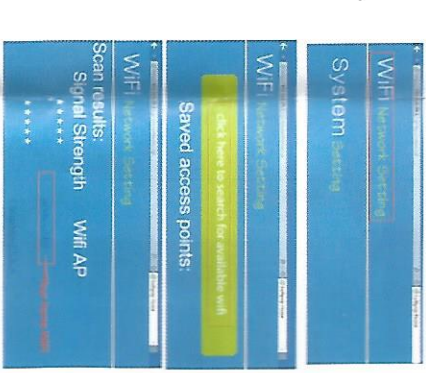

3. After the WIFI Setting above, MiraAdapter will reset and link to your home WIFI successful now. Next to make your phone link to home WIFI too.

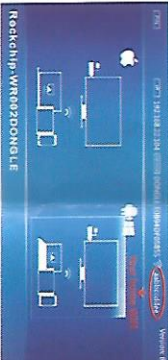

3. After the WIFI Setting above, MiraAdapter will reset and link to your home WIFI successful now. Next to make your PC/rebat link to home WIFI too.



4. "ACTION CENTER" -choose "Project" -- "Connect to a wireless display" -choose "DONGLE-E0894*****" then your PC/rebat screen cast to TV soon.



4. Pull out control center, choose "AirPlay mirroring" -----click "DONGLE-E0894*****" then your phone screen cast to TV soon.



5. Please confirm the miraadapter and phone / pad in the same router so that you can directly push out the shortcut menu and click Airplay Mirroring to cast screen. After each time of Use.

MiraAdapter for Android :

*Supports Android 4.2 above, and needed RAM 1G above
*Compatible with most of android phone and tablet
*Supports 1080p
*Needed the storage at least 40 M for the free space

Device connection :

For the first time setting --
1. "Setting" - "WLAN" choose "DONGLE-*****" and enter
(PIN) : 12345678

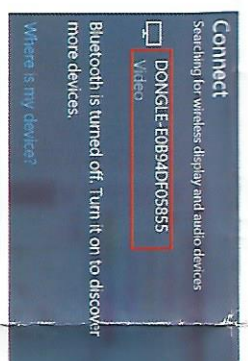

Bluetooth is turned off. Turn it on to discover more devices.
Where is my device?



MiraAdapter for MAC OS X :

Device connection :

For the first time setting --
1. "WLAN" choose "DONGLE-*****" and enter
(PIN) : 12345678

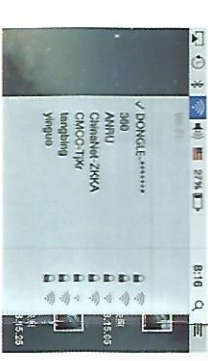

2. Enter IP:192.168.49.1 on browser to set WIFI, please link to your home WIFI too.

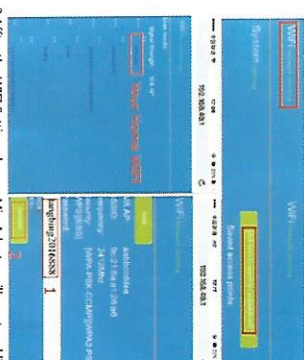

3. After the WIFI Setting above, MiraAdapter will reset and link to your home WIFI successful now. Next to make your phone link to home WIFI too.

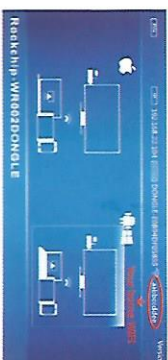

2. Enter IP:192.168.49.1 on browser to set WIFI, please link to your home WIFI too.



3. After the WIFI Setting above, MiraAdapter will reset and link to your home WIFI successful now. Next to make your MAC PC link to home WIFI too.

