

TIMING BELT

TIMING BELT

TIMING BELT REMOVAL/INSTALLATION

1. Disconnect the negative battery cable.
2. Remove in the order indicated in the table.
3. Install in the reverse order of removal.

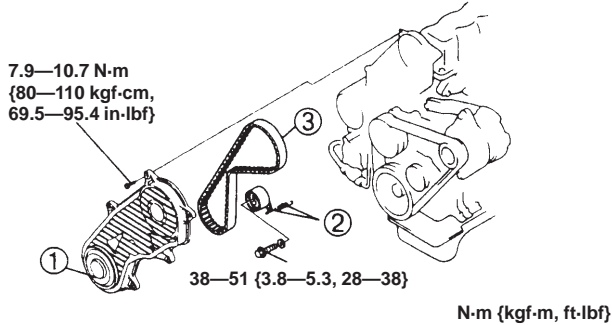

1	Timing belt cover + Installation Note
2	Tensioner, tensioner spring
3	Timing belt + Removal Note + Installation Note

Timing Belt Removal Note

Caution

- Forcefully twisting the belt, turning it inside out, or allowing oil or grease on it will damage the belt and shorten its life.

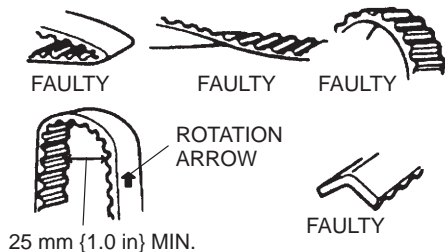

1. Mark the timing belt rotation on the belt for proper reinstallation.
2. Turn the crankshaft clockwise and align the timing marks as shown.

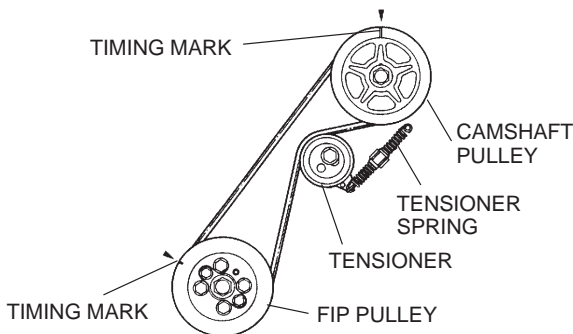

3. Remove the tensioner and tensioner spring.

Timing Belt Installation Note

1. Measure the tensioner spring free length. Replace the tensioner spring if necessary.

Free length
63.0 mm {2.48 in}

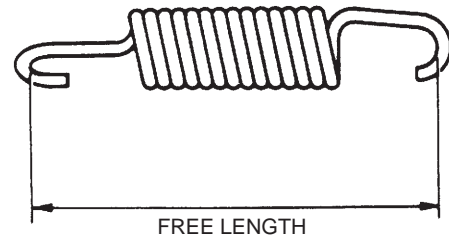

2. Turn the crankshaft clockwise and align the timing marks as shown.

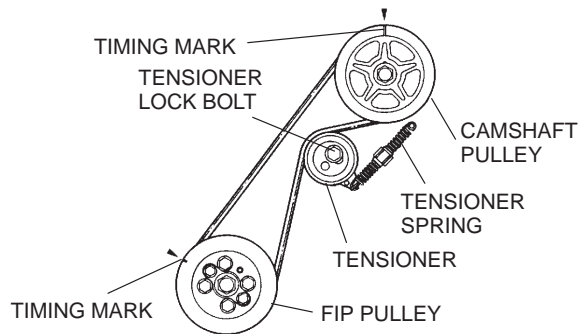

Caution

- Overtensioning of the timing belt can cause breakage of the belt and the camshaft.

3. Verify that the FIP attaching bolts and nuts are tightened to the specified torque. This must be done to prevent overtensioning of the timing belt after it has been installed.
4. Install the timing belt.
5. Install the tensioner, tensioner spring, and hand-tighten the lock bolt.
6. Turn the crankshaft clockwise twice, and align the timing marks. If they are not aligned, remove the timing belt and repeat from **Timing Belt Installation Note** Step 2.
7. Loosen the tensioner lock bolt to apply tension to the belt. Do not apply tension other than that of the tensioner spring.
8. Tighten the tensioner lock bolt. Be sure the tensioner does not move together with the bolt rotation.
9. Turn the crankshaft clockwise twice, and check the timing belt deflection as shown. If it is incorrect, repeat from **Timing Belt Removal Note**.

TIMING BELT

Timing belt deflection

9.0—10.0 mm {0.36—0.39 in} at
98 N {10 kgf, 22 lbf}

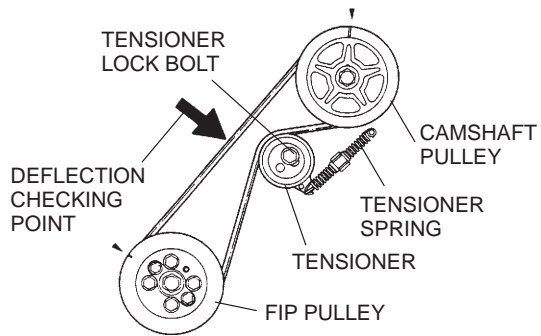

Timing Belt Cover Installation Note

- Tighten the timing belt cover bolts in the order shown.

